



X10D INTL Release Notes

Skydio X10D vehicle software version: **34.1.140**

Skydio X10D controller software version: **34.1.87**

3 September 2024

Skydio, Inc
3000 Clearview Way
San Mateo, CA 94402

X10D INTL RELEASE NOTES

NEW

Geofence

Set the range limits that your Skydio X10D may operate from the controller. By enabling this feature, the drone will be prevented from flying beyond the maximum set range.

Select the Flight Controls menu and the Limits tab, toggle on Range Limit, and set the range from 500 to 10,000 meters. You will be alerted when you reach the geofence boundary.

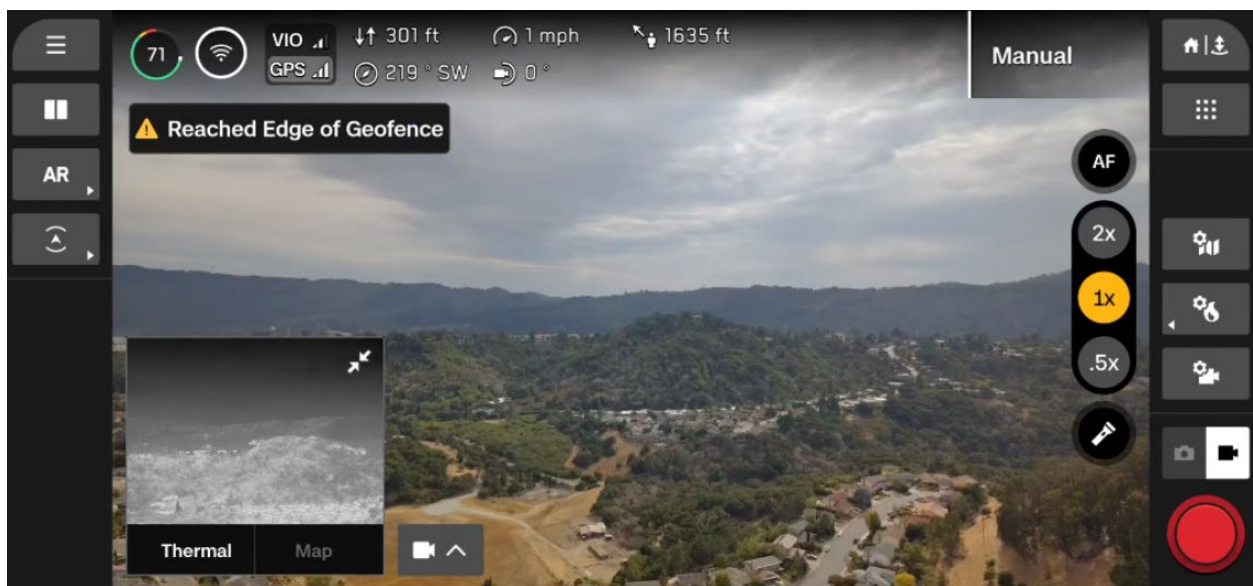
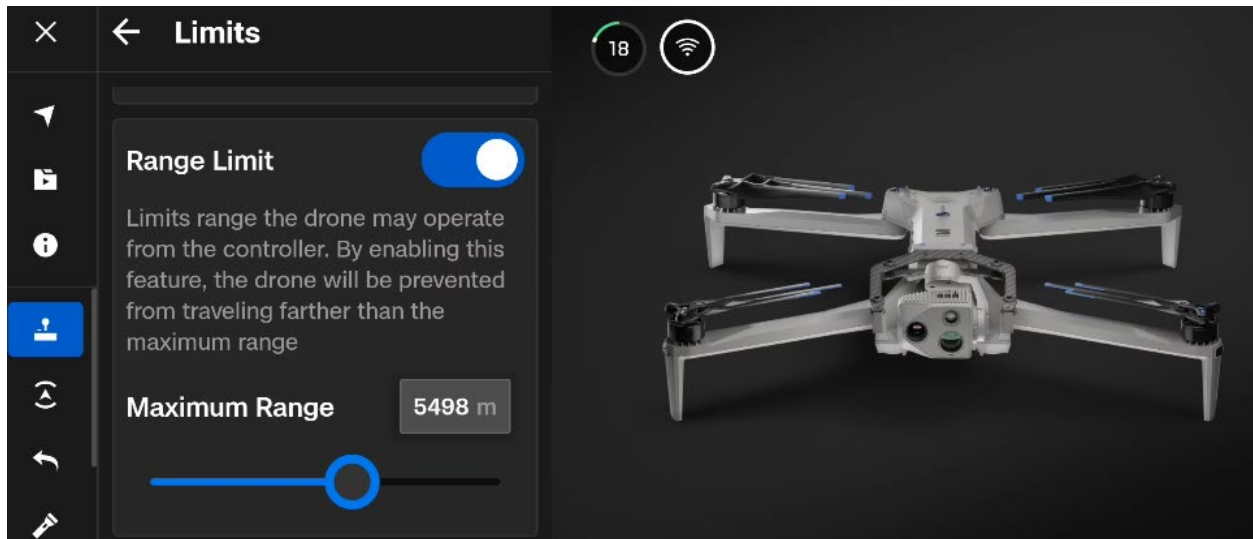

Proprietary - Do not duplicate or distribute without written permission from Skydio Inc.